

MFA New Device

- 1) Log into myRCC using code on Old Device if possible
Turn Off Old Device
Update mobile phone number in SIS if needed
- 2) Click **Your Name** in the upper-right corner
- 3) Click on **Enroll Mobile Device** to add the new device
(*Update Mobile Device* is only for changing the label)

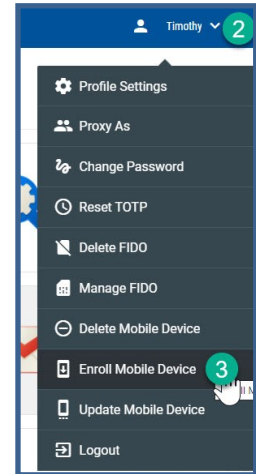

- 4) You will be informed that you are enrolling a mobile device.
Click **Continue** at the bottom of the window

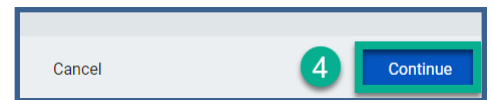

- 5) You will receive a text message on your mobile number in SIS and your preferred email.
This should be received on the new device.
A) If you have already installed the Rapid Identity App skip Step 1, go to Step 2.
B) Step 2—Tap the link in Step 2 of the Text

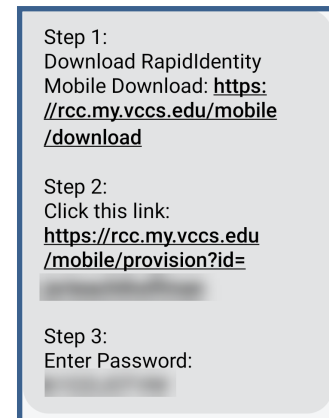

- 6) The Rapid Identity App will open for set up, you should see your username filled in, then be prompted for an **Authentication Code**—
Enter the Password in Step 3 for this.

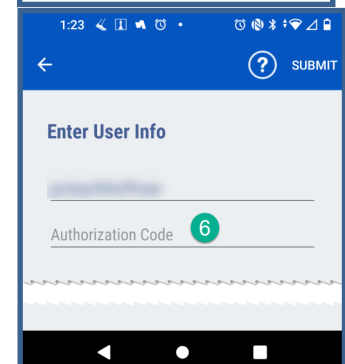

- 7) You will be taken to a dialog to set your PIN code for Ping Authentication.

You will be asked to confirm the PIN in the second box

- 8) You should receive a Success message:

