

# Embed a Studio Quiz—Gradebook

## This option is for informational quizzes that do not count in the Gradebook

Some Items to Keep in Mind:

- Quizzes must be created from your Studio My Uploads page.
- Once a version of a quiz has been embedded or taken, it **cannot** be edited.
- You must embed these quiz videos in a Rich Content Editor (not through Quizzes).

### 1) Create your Page to receive your Video Quiz

- A. In the target Module, click + Content button
- B. Select **Assignment**, then **New Assignment**
- C. Name your assignment and click **Add Item**

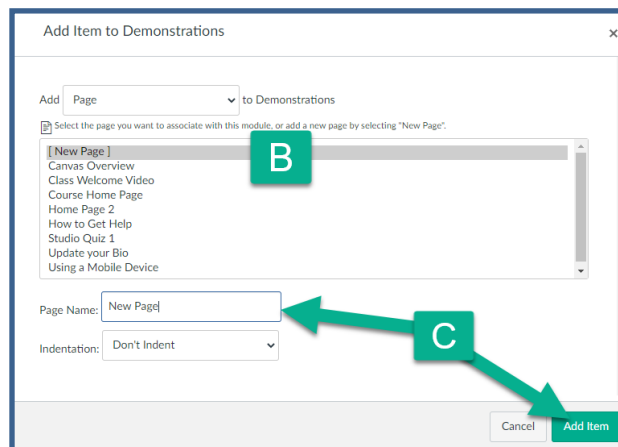
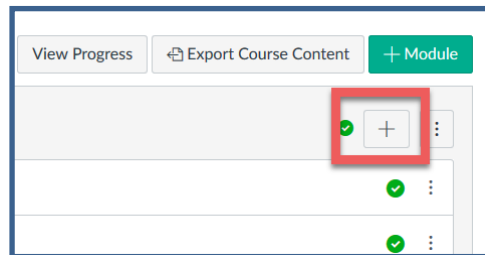

- D. Click the title to enter the page, click **Edit** in the Upper Right
- E. Use the Rich Content Editor (RCE) to enter any instructions or context you wish to add.

### 2) Configure your Video Quiz

- A. Configure your Assignment settings mostly as usual, assign total points, etc.
- B. In Submission Details:
  1. *Submission Type* = **External Tool**
  2. Use the **Find** button to **Select Studio**

As with other examples, find your video and Select it.

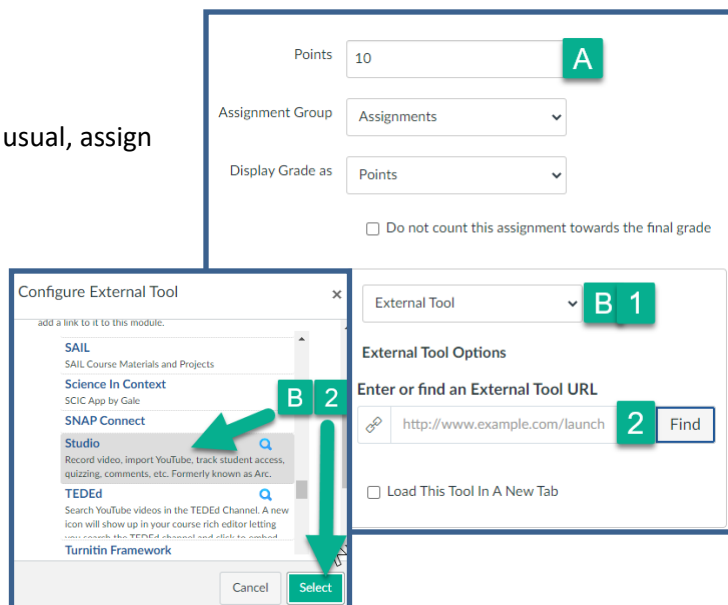

- C. When prompted, use the **Video Quiz Embed** option
- D. If multiple quizzes are in your video of choice, use the *Quiz* dropdown to select the desired quiz
- E. Click **Embed**

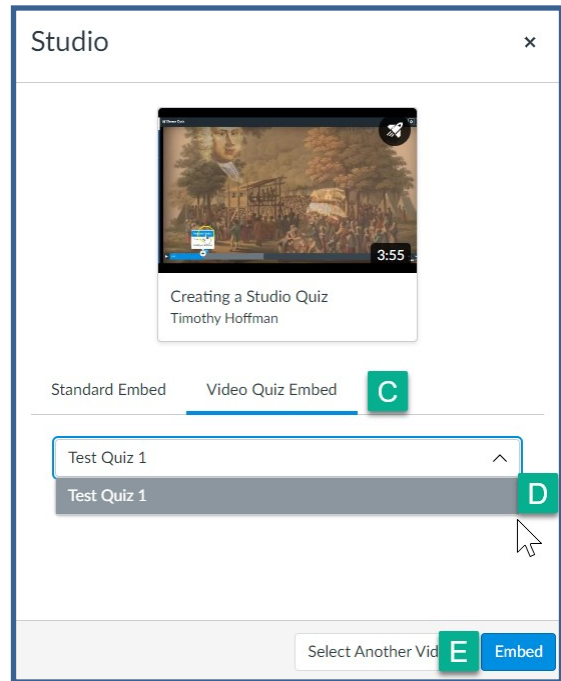
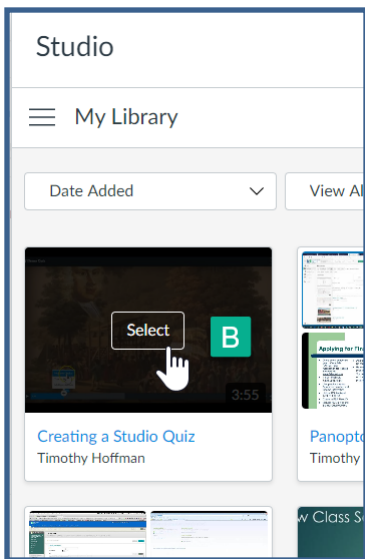

- F. The quiz will be added to the External Tool URL
- G. Click Select
- H. Complete your Assignment options such as Due Date and Availability Dates.
- I. **Save & Publish** to make this available to students in accordance with dates.  
**Save** if you only wish to save this but not have it available to students.  
 \* Available Dates do NOT affect Publish status.

